

Acoustical Panel Wall Coverage Z-Clip Installation

ATTENTION: If you have additional questions after reviewal of this manual please contact your local ASI representative or an ASI professional at our headquarters (952)448-5300

ASI MANUFACTURES DECORATIVE ACOUSTICAL PANELS AND PRODUCTS THAT MUST BE HANDLED WITH CARE. PRODUCTS SHOULD ONLY BE INSTALLED BY EXPERIENCED INSTALLERS.

RECEIVING

Prior to unpacking, check package for any obvious shipping damage. If no evidence of damage is present, move package to a dry/controlled area and inspect it for dents, breakage, or any lesser-noticeable damage that may affect enclosed panels. If damage has been identified, record it/photograph it, and open to inspect for concealed damage. If damage was transferred to the product, document/photograph the issues.

INSTALLATION

Good tools are needed to install panels. Care needs to be taken when cutting and fitting around windows, light switches and other penetrations. To achieve this, the following tools are recommended:

- Table Saw
- Miter Saw
- Jig Saw
- Hole Saw
- Standard Details pamphlet

Blades and bits must be sharpened, fine-tooth carbide. Jigsaw blades must be fine tooth.

The panels must be cut face up, when cutting on the table saw and miter box. When cutting with an jig saw care should be taken. All panels must be handled as fine furniture would be. Padded material should be used to avoid scratching or marring the face of the panels.

Penetrations in product (i.e. sprinklers, lighting, light switches, and outlets) should be cut with a jig saw using a sharp blade and bit or a sharp hole saw (reference details). Test cuts should be made on scrap panels to determine the proper tool speeds for cutting.

ASI recommends painting the walls or ceilings black at the perimeter to help conceal the expansion joints at the edges of the wall or ceiling system.

WALL INSTALLATION

ASI panels are designed to be installed on drywall, plywood, or furring of sufficient thickness and strength to support the product. Furring must be spaced as specified at the panel reveals such that the wall spline, if included, and horizontal z-bar provided can be directly attached. Installer is to determine width of furring to sufficiently support 2" wall spline and z-bar (reference standard details). Once furring or plywood is fully installed, wall spline and z-bar provided may be installed at architect-specified locations (see architectural drawings or shop drawings if provided). Wall spline may be finish nailed to furring or plywood. Z-bar fasteners are to be determined by installer depending on where on structure the product is to be attached.

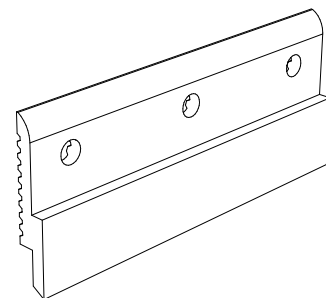

WALL Z-CLIP

WALL Z-CLIP/Z-BAR INSTALLATION INSTRUCTIONS - WALL COVERAGE

SHEET NUMBER

1

SCALE: AS NOTED

LAST REVISED: 1/31/2020

DRAWN BY: TL

ASI

123 Columbia Court North, Chaska,
Minnesota 55318 P. 800.527.6253

DO NOT SCALE DRAWING. FIGURED DIMENSIONS ARE TO BE FOLLOWED. READ THIS DRAWING IN CONNECTION WITH GENERAL ARCHITECTURAL PLANS, STRUCTURAL PLANS, AND OTHER RELATED DRAWINGS. THESE DRAWINGS REPRESENT ASI'S UNDERSTANDING AND INTERPRETATION OF THE ARCHITECTURAL DRAWINGS AND HOW ASI PRODUCTS RELATE TO THE PROJECT. COPYRIGHT ASI © 2020

Once z-bar and wall spline are properly installed, z-clips can be attached to panel backs at appropriate locations such that all reveals land on center of 2" wall spline and are located no more than 4" from the panel edge and 2' OC max. Z-clips may be installed using #8 - 5/8" screws provided, being sure to pre-drill holes into panel backs. Fully prepped panels may then be hung by setting panel on wall such that z-clips land above the z-bar. Slide panel down so that the z-clips seat into z-bar. Silicone should be added to at least one clip to secure 1/4" reveal.

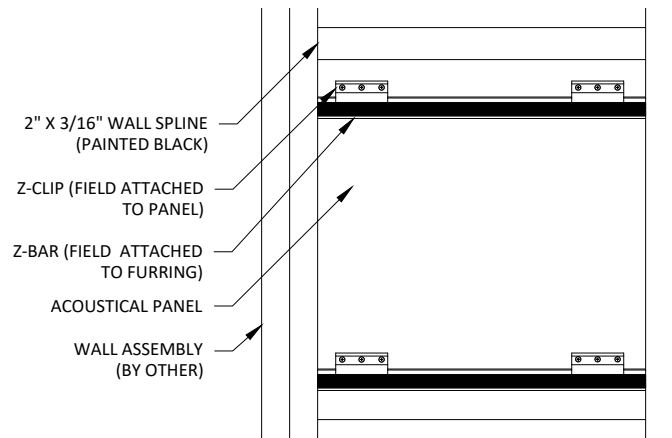

SPECIAL HANDLING INSTRUCTIONS

When handling product, care must be taken to not damage face of the panel. Handle all edges with care. To avoid damage, do not twist or bow the panels during installation.

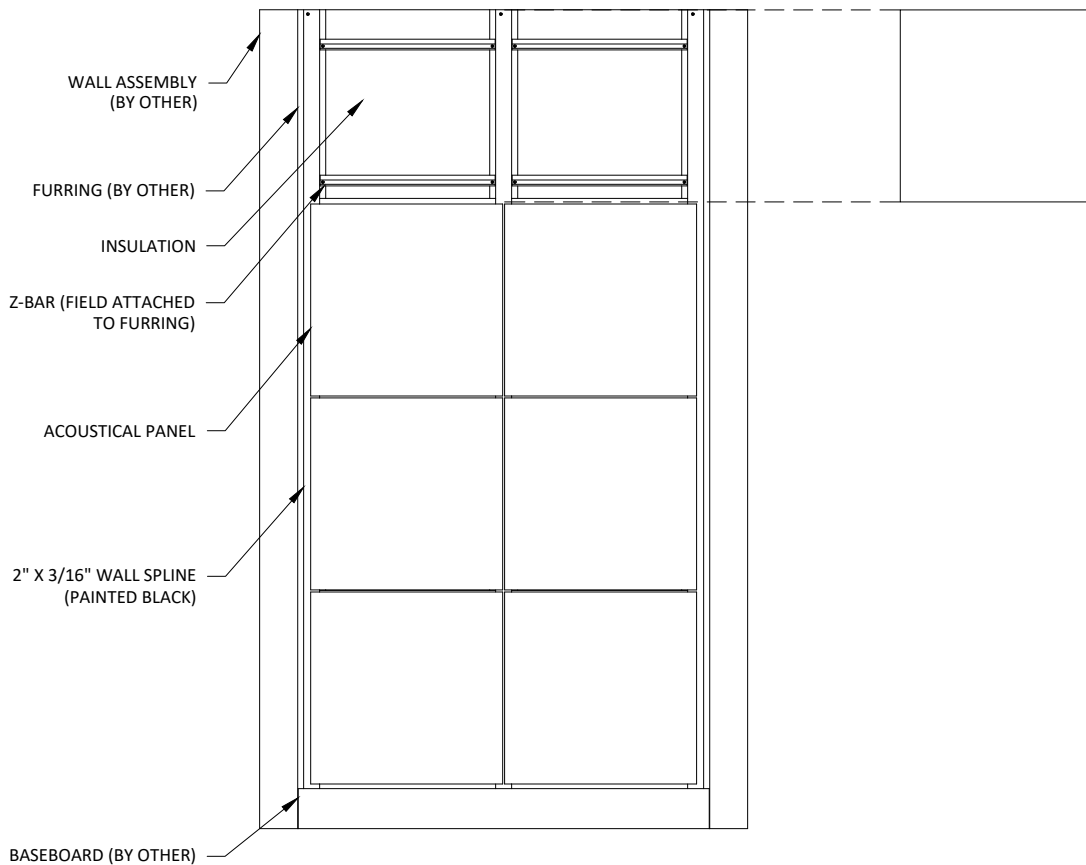

Acoustical Panel Wall Individual Z-Clip Installation

ATTENTION: If you have additional questions after reviewal of this manual please contact your local ASI representative or an ASI professional at our headquarters (952)448-5300

ASI MANUFACTURES DECORATIVE ACOUSTICAL PANELS AND PRODUCTS THAT MUST BE HANDLED WITH CARE. PRODUCTS SHOULD ONLY BE INSTALLED BY EXPERIENCED INSTALLERS.

RECEIVING

Prior to unpacking, check package for any obvious shipping damage. If no evidence of damage is present, move package to a dry/controlled area and inspect it for dents, breakage, or any lesser-noticeable damage that may affect enclosed panels. If damage has been identified, record it/photograph it, and open to inspect for concealed damage. If damage was transferred to the product, document/photograph the issues.

INSTALLATION

Install clips on the back of the panel at marked locations. The raised edge of the clip should face the bottom edge of the panel. Measure the distance between the center of each bracket on the back of the panel, between top and bottom clips horizontally and vertically.

[For curve diffusors clips are not needed on the diffusor itself. Measure the distance between the center of each bracket on the back of the curve diffusor. There are two brackets on the top and two on the bottom. Then follow the steps below].

Attach the first clip to the desired location on the wall with the raised edge facing up using the supplied drywall anchors and screws. Using a bubble level and tape measure, mark the locations of the remaining clips. Ensure that the clips are level with one another. If installing on a concrete wall, we recommend using concrete anchors (not included) in the wall prior to installing the clips.

Once all clips are installed, slide the panel down onto the wall clips. The panel attachments should fit securely in the wall clips. Check your work with the bubble level. Adjust as necessary.